

RECOMMENDED PANEL MOUNTING

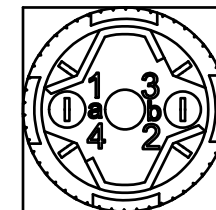
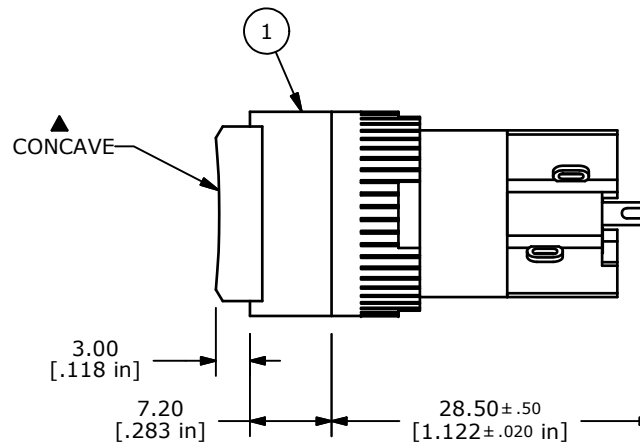
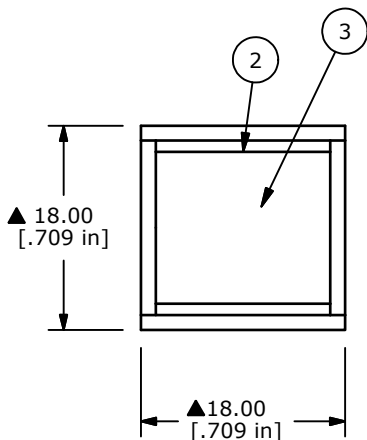
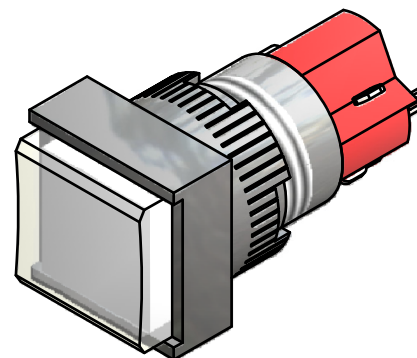
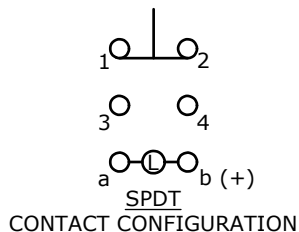

NOTE:

1. ALL DIMENSIONS IN MM [INCH].
2. GENERAL TOLERANCE: X.X=±0.4  
X.XX=±0.25
3. TERMINAL NUMBERS FOR REF ONLY.
- ▲ 4. CONTACT RATING: 5A @ 250VAC,  
8A @ 125VAC,  
6A @ 24VDC
5. ELECTRICAL LIFE: 50,000 OPERATIONS
6. INSULATION RESISTANCE: 1,000 MEGA-OHM MIN.
7. CONTACT MATERIAL: SILVER PLATED COPPER ALLOY
- ▲ 8. ACTUATION FORCE: 300g / POLE
9. OPERATING TEMP.: -25°C to +55°C
10. ▲ DENOTES CRITICAL PARAMETER.
11. 2002/95/EC (ROHS) COMPLIANT

| PARTS LIST |     |             |  |
|------------|-----|-------------|--|
| ITEM       | QTY | PART NUMBER | DESCRIPTION                                |
| 1          | 1   | F040008     | D16OAS11                                   |
| 2          | 1   | F050305     | 50-003-05 WHITE LENS                       |
| 3          | 1   | F050406     | 50-004-06 LAMP INCANDESCENT 48V AC/DC 25mA |



|     |        |                           |         |     |
|-----|--------|---------------------------|---------|-----|
| B   | 19795  | DRAWING CLEAN UP / UPDATE | 3/28/11 | BGL |
| REV | PCR NO | DESCRIPTION               | DATE    | BY  |

|                    |           |     |         |     |
|--------------------|-----------|-----|---------|-----|
| TITLE D16OAS11DWHT |           |     |         |     |
| SCALE              | DATE      | DR  | DWG     | REV |
| 1.5:1              | 3/28/2011 | BGL | XF0455P | B   |

THE INFORMATION CONTAINED IN THIS DOCUMENT IS PROPRIETARY TO E-SWITCH AND IS NOT TO BE COPIED OR TRANSFERRED